

Integrated Washing Machine

HJA 8514

Installation & Operating Instructions



Lamona

Introduction

Please read these instructions for use carefully and all other information enclosed with the washing machine.

Keep all documentation in a safe place for future reference or for any future owners.

Note: this machine is solely for domestic use.

Notes on disposal

All packaging material used is environmentally-friendly and recyclable. Please help dispose of the packaging via environmentally-friendly means.

Your supplier or local council will be able to give you details of current means of disposal.

Valuable materials can be salvaged from an old appliance via scrap reprocessing.

Note: pull out the mains plug from any old appliance. Cut the power cable and dispose of it, together with the plug.

When disposing of an old washing machine, please ensure that the door lock is rendered inoperable to prevent children shutting themselves in the appliance.

Contents

Page

Introduction	2
General delivery notes	4
Safety notes	4
Quick start	5
Description of controls	6
Programme Table	12
Programme selector	14
Detergent drawer	17
Detergents, washing aids and amounts to use	18
Useful advice for the user	20
The main wash	21
Cleaning and routine maintenance	23
Investigating malfunctions	24
Technical data	26
Setting up + installation	27

BEFORE SWITCHING ON THE APPLIANCE MAKE SURE IT IS CORRECTLY INSTALLED AND THAT THE TRANSIT BRACKETS ARE REMOVED AS SHOWN IN PAGE 27.

General delivery notes

Please check that the following items are delivered with the appliance:

- Instruction manual
- Certificate of guarantee
- Inlet hose

Check that no damage has occurred during transit, and if so, call your nearest Authorised Technical Support Service agent.

Safety notes

Note:
for cleaning or maintenance of the washing machine.

- A) Pull out the plug
- B) Turn off the tap
- C) Do not touch the appliance when hands or feet are wet or damp. Do not use the appliance with bare feet.
- D) The use of adapters, multiple connectors and/or extensions is not recommended.

Note:
water temperature can reach 90°C during the wash cycle.

- E) Check there is no water left in the drum before opening the door.
- F) This appliance is not intended for use by persons (including children) with reduced physical, sensory or mental capabilities, or lack of experience and knowledge, unless they have been given supervision or instruction concerning use of the appliance by a person responsible for their safety.
Children should be supervised to ensure that they do not play with the appliance.
- G) Do not pull the power cable or the appliance itself to remove the plug from the socket.
- H) The appliance must not be exposed to weather conditions (rain, direct sun, etc...)
- I) When moving the appliance never lift it by the controls or by the detergent drawer.
When in transit never rest the door against the trolley or transport the appliance without the polystyrene base.

L) **N.B!**

If the appliance is installed on a carpeted floor ensure that the ventilation holes on the base of the appliance are not obstructed.

- M) If the appliance is not running properly or breaks down, switch it off, turn off the tap and do not tamper with the appliance.

Consult only the Authorised Technical Support Service for possible repair and ask them to use original spare parts.

Failure to comply with the above can compromise the safety of the appliance.

- N) If the appliance's power cable should ever need replacing, consult the Authorised Technical Support Service

Quick start

Washing

- Open the door by using the button "A" (Fig. 1, page 6)
- Select laundry and put it in the machine
- Close the door
- Put detergent in the compartments as indicated in the programme guide in this instruction manual
- Select programme
- Wait for the "STOP" indicator light to flash

Press additional function buttons (if required)

- Press the "Start/Pause" button (page 7)
- After few seconds the appliance starts working.

After washing

- The indicator light "STOP" will go on.
- Wait for the door lock to be released (about 2 minutes after the programme has finished).
The "Door Security" indicator light will go out.
- Switch off the washing machine by turning the selector to "OFF" position.
- Open the door and remove the laundry.

Ensure that the machine is correctly installed in line with the instructions found on page 27.

Description of controls

Fig. 1

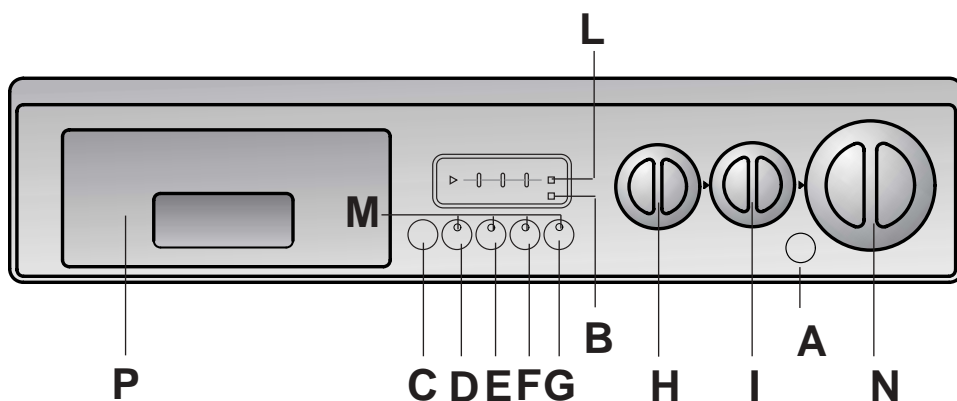

Door open button	A
Door locked indicator light	B
Start button	C
Start Delay button	D
Prewash button	E
Extra Rinse button	F
Crease Guard button	G
Spin Speed Control Knob	H
Wash temperature control knob	I
"Time to end" indicator light	L
Buttons indicator light	M
Timer knob for wash programmes with OFF position	N
Detergent drawer	P

Door open button

A

Important:

A special safety device prevents the door from opening at the end of the wash/spin cycle. At the end of the spin phase wait up to 2 minutes before opening the door.

DOOR SECURITY indicator light

B

The "**Door Security**" indicator light is illuminated when the door is fully closed and the machine is ON. When "**Start/Pause**" is pressed on the machine with the door closed the indicator will flash momentarily and then illuminate.

If the door is not closed the indicator will continue to flash.

A special safety device prevents the door from being opened immediately after the end of the cycle. Wait for 2 minutes after the wash cycle has finished and the "**Door Security**" light has gone out before opening the door. At the end of the cycle turn the programme selector to "**OFF**".

START/PAUSE button

C

When a programme is selected, wait for the "STOP" indicator light to flash before pressing the "Start/Pause" button.

Press to start the selected cycle (according to the selected cycle one indicator light will go on).

NOTE: When the "Start/Pause" button has been pressed, the appliance can take a few seconds before it starts working.

Changing the settings after the programme has started (PAUSE)

The programme may be paused at any time during the wash cycle by holding down the "**Start/Pause**" button for about two seconds. When the machine is in the paused mode, the indicator light "**Time to end**" and option buttons will flash.

To restart the programme, press the "**Start/Pause**" button once again.

If you wish to add or remove items during washing, wait 2 minutes until the safety device unlocks the door.

When you have carried out the manoeuvre, close the door, press "**Start/Pause**" button and the appliance will continue working where it left off.

CANCELLING THE PROGRAMME

To cancel the programme, set the selector to the OFF position.

Select a different programme.

Re-set the programme selector to the OFF position.

The option buttons should be selected before pressing the "Start/Pause" button.

START DELAY BUTTON

D

Appliance start time can be set with this button, delaying the start by 3, 6 or 9 hours.

Proceed as follow to set a delayed start:

Select a programme ("STOP" indicator light blinks)

Press Start Delay button (each time the button is pressed the start will be delayed by 3, 6 or 9 hours respectively and the corresponding light will blink).

Press START to commence the Start Delay operation (the indicator light associated with the selected Start Delay time stops blinking and remains ON).

At the end of the required time delay the programme will start.

To cancel the Start Delay function:

press the Start Delay button until the indicator lights will be off (The STOP light blinks) and the programme can be started manually using the START button or switch off the appliance by turning the programme selector to off position.

PRE-WASH BUTTON

E

This option is particularly useful for heavily soiled loads and can be used only on some programmes as shown in the programmes table.

Detergent for this programme should be added to the compartment of the soap drawer labelled "I" (Please refer to Detergent Drawer Section of manual). We recommend you use only 20% of the recommended quantities shown on the detergent pack and fabric conditioner should not be used for this programme.

EXTRA RINSE BUTTON

F

Thanks to the new electronic system selecting the 'Extra Rinse Button' will enable the machine to perform a special rinse cycle. This function is ideal for people with sensitive skin as it removes more of the detergent from the washing. It is advisable to use this function for very dirty loads where extra detergent has been used and for washing towelling items whose fibres have a tendency to retain detergent.

This option is only available on the SPORT programme in the SPECIAL programmes options.

CREASE GUARD button

G

Press the button to select or deselect this function.

The Crease Guard function minimizes creases as much as possible with a uniquely designed anti-crease system that is tailored to specific fabrics.

MIXED FABRICS - the water is gradually cooled throughout the final two rinses with no spinning and then a delicate spin assures the maximum relaxation of the fabrics.

DELICATE FABRICS – final two rinses with no spinning and then the fabrics are left in water until it is time to unload. When you are ready to unload, press the "**Crease Guard**" button – this will drain.

WOOLLENS/SILK – after the final rinse the fabrics are left in water until it is time to unload and the button indicator blinking.

When you are ready to unload, press the "**Crease Guard**" button, this will drain and spin ready for emptying.

If you do not want to spin the clothes and activate drain only:

- Turn the programme selector to the "**OFF**" position;
- Select programme drain only  ;
- Switch on the appliance again by pressing the "**Start/Pause**" button.

SPIN SPEED CONTROL

H

ROTATES IN BOTH DIRECTIONS

The spin cycle is very important to remove as much water as possible from the laundry without damaging the fabrics. You can adjust the spin speed of the machine to suit your needs. By adjusting the control, it is possible to reduce the maximum speed, and if you wish, the spin cycle can be cancelled altogether-position .

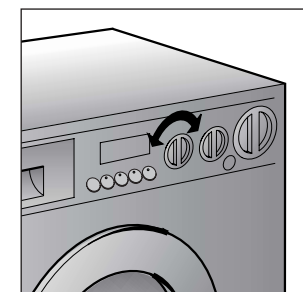

Note:

The machine is fitted with a special electronic device, which prevents the spin cycle should the load be unbalanced.

This reduces the noise and vibration in the machine and so prolongs the life of your machine.

WASH TEMPERATURE CONTROL KNOB

I

ROTATES IN BOTH DIRECTIONS

With this device it is possible to reduce, but not increase washing cycle temperature. The table of programmes indicate the maximum temperature advised for each type of wash.

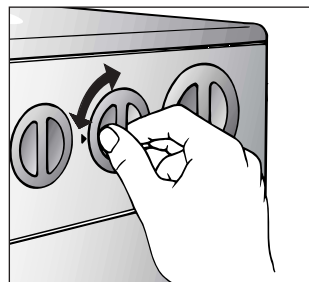

WARNING: THIS TEMPERATURE MUST NEVER BE EXCEEDED

TIME TO END indicator light

L

In order to manage your time better, this washing machine features an indicator light system that keeps you constantly informed on the remaining cycle time.

Indicator light START:

Remaining time above 60 minutes.

Indicator light 60:

Remaining time less than 60 minutes.

Indicator light 30:

Remaining time less than 30 minutes.

Indicator light 15:

Remaining time less than 15 minutes.

Indicator light STOP:

End of the programme.

Buttons indicator light

M

The indicator light around the option buttons will light when specific options are selected. If you select an option button that is not compatible with the programme required the button light will not illuminate.

PROGRAMME selector with "OFF" position

N

Rotates in both directions.

The machine is turned on by selecting a programme via the programme selector. This status will be indicated by the "STOP" indicator light flashing, this light will continue to flash until the machine has started or the machine is returned to the "OFF" position.

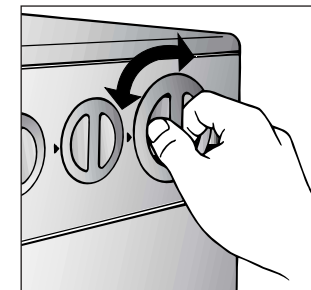

Press the **"Start/Pause"** button to start the selected cycle.











Once a programme is selected the programme selector remains stationary on the selected programme till cycle ends.

Switch off the washing machine by turning the selector to **"OFF"**.

Note:

The programme selector must be returned to the "OFF" position at the end of each cycle or when starting a subsequent wash cycle prior to the next programme being selected and started.

TABLE OF PROGRAMMES

PROGRAM FOR	PROGRAMME SELECTOR ON:	WEIGHT MAX Kg	TEMP. °C	CHARGE DETERGENT		
				II	☼	I
Resistant fabrics Cotton, linen	 90°C	6	Up to: 90°	●	●	(●)
Cotton, mixed resistant	 60°C (*)	6	Up to: 60°	●	●	(●)
Cotton	 40°C	6	Up to: 40°	●	●	(●)
Resistant fabrics	40°C AA	6	Up to: 40°	●	●	
Mixed fabrics and synthetics Mixed, resistant	 50°C	3	Up to: 50°	●	●	(●)
Very delicate fabrics	 40°C	2	Up to: 40°	●	●	
RINSE SPIN DRAIN ONLY		-	-		●	
		-	-			
		-	-			
Specials	WOOLMARK  40°C	1	Up to: 40°	●	●	
	SILK – HAND WASH  30°C	1	Up to: 30°	●	●	
	MIXED FABRICS Sport	2,5	Up to: 30°	●	●	
	RESISTANT FABRICS R» A 59'	3	Up to: 60°	●	●	
	RESISTANT or MIXED FABRICS R» 44'	3,5	Up to: 40°	●	●	
	RESISTANT or MIXED FABRICS R» 29'	2	Up to: 40°	●	●	

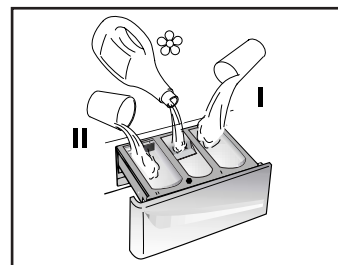

Please read these notes

When washing heavily soiled laundry it is recommended the load is reduced to 3 kg maximum.

* Programme also recommended for low temperature wash (below the indicated Max. temperature). Programmes according to CENELEC EN 60456.

The spin speed may also be reduced, to match any guidelines suggested on the fabric label, or for very delicate fabrics cancel the spin completely.

(●) Only with the Prewash button selected. (Programmes with Prewash button available)

■ The variable temperature selector allows a reduction in the wash temperature in each programme.

ATTENTION: With the temperature selector on the 0 position the programme will be performed with a cold wash.

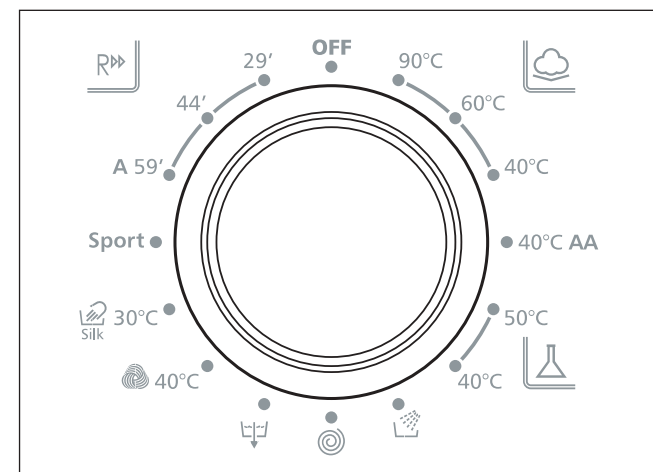

Programme selector

For the various types of fabrics and various degrees of dirt the washing machine has different programme bands according to: wash cycle, temperature and length of cycle (see table of washing cycle programmes).

1 RESISTANTS FABRICS

The programmes have been designed for a maximum wash and the rinses, with spin intervals, ensure perfect rinsing. The final spin gives more efficient removal of water.



• 90°C
• 60°C
• 40°C

AA SPECIAL PROGRAMME AT 40°C

This special programme has been studied to allow you to obtain the best washing performance, even at full load, as the 60°C Cotton programme (the normative cycle), but with the advantage of an energy saving due to 40°C temperature, instead of 60°C.

40°C AA

2 MIXED AND SYNTHETIC FABRICS

The main wash and rinse gives the best results thanks to the rotation rhythms of the drum and to the water levels. A gentle spin will mean that the fabrics become less creased.



• 50°C

3 SPECIAL DELICATE FIBRES

This is a new wash cycle which alternates washing and soaking and is particularly recommended for very delicate fabrics. The wash cycle and rinses are carried out with high water levels to ensure best results.



• 40°C

4. SPECIALS

SPECIAL “RINSE” PROGRAMME

This programme carries out 3 rinses with a intermediate spin. It can be used for rinsing any type of fabric, eg. use after hand-washing.



SPECIAL “FAST SPIN” PROGRAMME

Programme “FAST SPIN” carries out a maximum spin.



DRAIN ONLY

This programme drains out the water.



WOOLMARK PROGRAMME

A programme dedicated to washing fabrics labelled with the woolmark. The cycle comprises of alternate periods of activity and pauses. The programme has a maximum temperature of 40° and concludes with 3 rinses and a short spin.



40°C

SPECIAL SILK PROGRAMME

This washing machine also has a gentle Silk and Hand Wash programme cycle. This programme allows a complete washing cycle for garments specified as ‘Hand Wash only’ and laundry items made from Silk on the fabric label.

The programme has a maximum temperature of 30° and concludes with 3 rinses and no final spin.



30°C

SPORTS

The washing machine has a unique Sportswear programme. It is specially designed to wash mixed sportswear fabrics that cannot be washed on hotter programmes and is designed to remove the soil and staining created by participation in sports activities. This programme starts with a cold prewash that breaks down and loosens any excess dirt and then washes at a cool 30°C, rinses and spins slowly for the best care of your heavily soiled, delicate garments.

Sport

“A” WASH 59'

This specially designed programme maintains the high quality wash performance identified with the “A” rating whilst greatly reducing the wash time. The programme is designed for a maximum load of 3 kg with a temperature of 60°C and concludes with 2 rinses and a high speed spin sequence.

A 59'

DAILY WASH 40°C – FAST PROGRAMMES

By maintaining exceptional washing performance, these programmes allow you to know in advance the necessary time for your everyday laundry. In fact, this washing machine is equipped with 2 daily rapid programmes at 40°C, that were just studied for lightly soiled fabrics and medium or little load.

DAILY WASH 40°C – FAST 44'

A complete washing cycle (wash, rinse and spin), able to wash in approximately 44 minutes:

- a maximum load of 3,5 kg;
- lightly soiled fabrics (cotton and mixed fabrics)

We recommend, with this programme, a 30% detergent loading dose (compared to the normal one), in order to avoid detergent waste.

44'

DAILY WASH 40°C – FAST 29'

A complete washing cycle (wash, rinse and spin), able to wash in approximately 29 minutes:

- a maximum load of 2 kg;
- lightly soiled fabrics (cotton and mixed fabrics)

We recommend, with this programme, a 20% detergent loading dose (compared to the normal one), in order to avoid detergent waste.

29'

Automatic Variable Capacity

The washing machine is fitted with an automatic reduction in consumption system (known as Automatic Variable Capacity).

This system enables the machine to use the amount of water needed to wash and rinse the laundry in relation to the particular load.

This results in a reduction in the amount of water used and electricity needed to heat it to the minimum required, without in any way compromising the washing and rinsing performance. In fact the amount of water and electricity used will always be appropriate for the amount of washing.

The washing machine therefore ensures you achieve excellent washing results whilst respecting the environment and saving you money.

Detergent drawer

P

The detergent drawer is split into 3 compartments:

- the compartment labelled "I" is for prewash detergent;
- the compartment labelled "☼" is for special additives, fabric softeners, fragrances, starch, brighteners etc;
- the compartment labelled "II" is for main wash detergent.

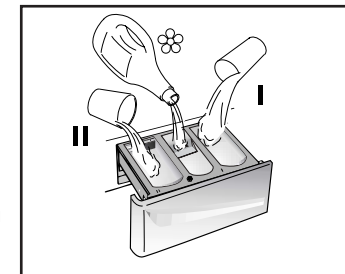

NOTE:

Some detergents are difficult to utilise. Ensure to use an in drum dispenser if recommended by the detergent manufacturer.

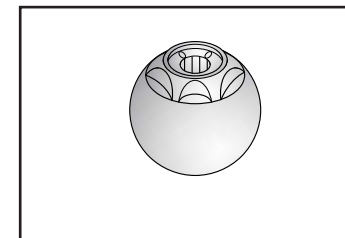

Note: Only put liquid products in the compartment labelled "☼". The machine is programmed to automatically take up additives during the final rinse stage for all wash cycles.

Detergents, washing aids and amounts to use

Choice of detergent

General purpose detergents

- **Powder detergents**, for a thorough wash, with bleaching agent, particularly suitable for use in hot wash programmes (60°C and over), for heavily soiled and stained laundry.
- **Liquid detergents**, particularly suitable for grease stains, such as greasy skin marks, cosmetics and oil.
These detergents are not suitable for washing stained laundry, as they do not contain bleach.
- **Biological detergents**, not all the products available give a really thorough wash.

Additional laundry aids

- **Water softener**, means less detergent can be used where water hardness is classed as hard to very hard.
- **Prewash substances**, for the programmed treatment of stains prior to the main wash. Using them means the subsequent wash can be at a low temperature or with bleach-free detergents.
- **Fabric softener**, prevents static build-up in synthetic fabrics and softens fabrics. If you own a tumble dryer, clothes are softened even without the use of a fabric softener.

Do not put solvents in the washing machine!

Keep detergents and other laundry products out of children's reach.

Before pouring in the detergent check that there are no foreign bodies in the detergent drawer.

Dosage details are usually shown on the detergent packaging. Follow those instructions.

Dosages

Only use detergents which are suitable for use in a washing machine.

You will obtain the best results from your wash with the minimum use of chemical products and the best care for your laundry if you take into consideration the degree of soiling as well as the type of detergent to choose.

The amount of detergent to use depends on:

- water hardness: depending on the hardness of the water and the type of detergent used, it is possible to reduce the amount of detergent.
- the degree of soiling: it is possible to reduce the amount of detergent used depending on the degree of soiling.
- amount of laundry: it is possible to reduce the amount of detergent when washing only a small amount of laundry.

Dosage for powder detergent

For normal and low concentration detergents: for normally soiled laundry choose a programme without prewash.

Put the detergent in compartment "II" of the drawer.

For heavily soiled laundry, choose a programme with prewash.

Put 1/4 of the detergent in compartment "I", 3/4 in compartment "II" of the drawer.

When using water softeners, first put in the detergent, then add the softener to compartment "II".

For highly concentrated detergents not in single dose format, follow what is shown on pack exactly as regards type and amount of dosage.

To avoid the difficulty of checking if the detergent has been taken up, use the dosage aids provided in the detergent packaging.

Liquid detergent dosage

Liquid detergents may be used in accordance with the instructions on the relevant packaging, for all programmes without prewash, by using the special container which is placed in the drum or, for those models that have it, in the special insert for liquid detergents.

Useful advice for users

Tips on using your domestic appliance in the most environmentally-friendly and economical way

Do a full load in your washing machine

To prevent any possible waste of energy, water or detergent we recommend that you put a full load in your washing machine, not exceeding the recommended maximum load size. Up to 50% energy saving can be made with one full load compared to two half load washes

When is prewashing really needed?

Only with particularly dirty loads!

Energy savings of 5 to 15% are made by not selecting the prewash option for normal soiled laundry.

Which wash temperature should you choose?

Using stain removers before machine washing reduces the need to wash at temperatures over 60°C.

Energy savings of up to 50% can be made by using a 60°C wash temperature rather than 90°C.

Main wash

Sorting the laundry

- It is recommended you wash only items which are machine washable with water and detergent and not dry-clean items.
- If you need to wash rugs, bedspreads or other heavy items, it is best not to spin them.
- Sort the laundry according to fabric type, degree of soiling and wash temperature: Always follow the wash care advice on the garment label for the most suitable care and treatment of the laundry

Laundry for hot wash 95°

Coloured, easy-care materials 60° 50° 40°

Delicates and wool 40° 30°

Wash by hand 

Items labelled with the following symbol are not suitable for machine washing:

Dry clean 

For very delicate items, such as net curtains, underwear, tights etc., you are advised to use a laundry net or wash bag.

- Woollen items must be labelled with the "Pure New Wool" symbol to be washed in the machine , and must also be labelled "non-matting" or "machine washable".
- Colour often leaks from new coloured items.

This can then colour other lighter items being washed.

We therefore recommend that coloured items should be washed for the first time separately.

For future washes, colourfast items can only be washed with whites up to 40°C.

Note: when sorting laundry

- check there are no metal objects in the laundry (such as paper clips, safety pins, pins, coins etc...);
- button up pillowcases, fasten zips, hook & eye fasteners, belts and long dressing gown cords;
- remove curtain hooks;
- pay close attention to the labels on items
- if you notice stubborn stains whilst sorting the laundry, remove them using a special detergent or a special stain remover.

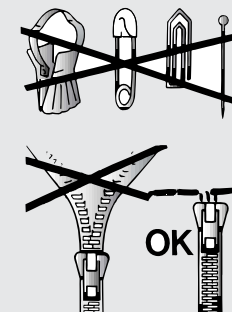

- We recommend that you do not do a full load of towelling items only as these become too heavy since they absorb a lot of water.

The correct way to wash

Preparing the laundry

A) Select the laundry.

Loading the laundry

B) Open the porthole.

C) Put the laundry in the washing machine.

Close the porthole again, ensuring that no items of laundry are obstructing the lock.

Putting detergent in machine

D) Open the drawer, choose the detergent and put in the correct amount, according to the manufacturer's instructions and the advice on page 18.

Add any other laundry aids (see page 18). Close the drawer again.

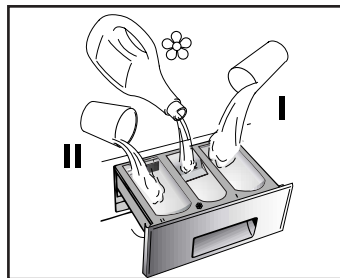
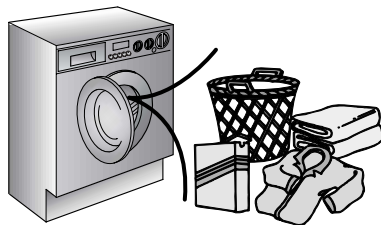

Selecting the wash programme

Refer to the programme guide or the programme descriptions on the machine to select the most suitable programme.

Turning the selector knob, the required programme is activated.

Wait for the **"STOP"** indicator light to flash.

Press additional function buttons (if required).

Check that the tap is turned on and that the discharge hose is positioned correctly.

Press the **"Start/Pause"** button.

When the **"Start/Pause"** button is pressed the machine sets the working sequence in motion.

The programme carries out with the programme selector stationary on the selected programme till cycle ends.

Warning: If there is any break in the power supply while the machine is operating, a special memory stores the selected programme and, when the power is restored, it continues where it left off.

When the programme is finished

At the end of the programme the indicator light **"STOP"** will go on.

Wait for the door lock to be released (about 2 minutes after the programme has finished).

The **"Door Security"** indicator light will go out.

Switch off the machine by turning the programme selector on the **"OFF"** position. Open the door and remove the laundry. Turn off the tap.

Cleaning and routine maintenance

Do not use alcohol-based scourers and / or thinners on the outside of your washing machine, just a wipe with a damp cloth will suffice. The washing machine needs very little maintenance:

- Cleaning the drawer compartments.
- Cleaning the door glass.

Cleaning the drawer compartments

Even if it is not strictly necessary, it is good to clean the compartments for bleaching detergents and additives occasionally.

- A) To do this you just need to pull them out firmly, but without forcing them.
- B) Clean everything in the compartment under running water.
- C) Put everything back in its proper place.

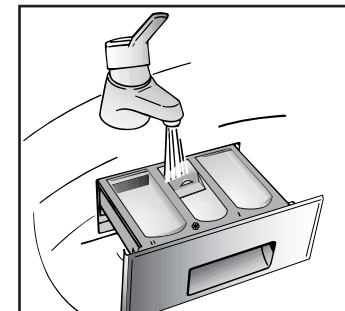

Cleaning the door glass

Regularly clean the door glass with a damp cloth. A build up of soiling and residues from the water may result in water leaking from the door.

Do not use abrasive cleaners as they can scratch the surface.

Transporting the appliance or long periods when appliance is not in use

If the appliance is being transported or is out of use for long periods in unheated places, all remaining water must be completely removed from the hoses.

Ensure mains power is off, then unclip the hose and point it downwards into a basin until all the water has emptied out.

When finished, repeat the operation in the reverse order.

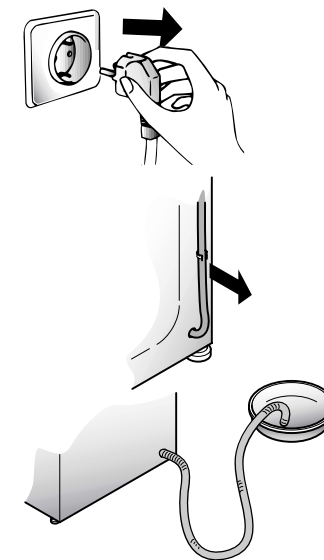

Investigating malfunctions

What might be the cause of...
Defects you can remedy yourself

MALFUNCTION	CAUSE	REMEDY
1. Does not work on any programme	Plug not in socket. Not switched on. Power failure. Fuse blown. Door open.	Plug it in. Switch on. Check. Check. Close door.
2. Does not fill with water	See cause 1. Tap turned off. Programme selector not correctly positioned. Fill hoses are kinked	Check. Turn on tap. Position programme selector correctly. Straighten fill hoses
3. Water does not drain away	Kink in discharge hose. House drain is blocked	Straighten discharge hose. Clean drain
4. Water on floor around the washing machine	Leaking gasket between tap and water inlet hose. House drain is blocked Soap drawer blocked with soap residues	Replace gasket and tighten hose and tap well. Clean drain Clean soap drawer
5. Does not spin	Water has not yet drained away. "No spin" selected (certain models only).	Wait a few minutes for machine to empty. Reset button or turn "no spin" knob.
6. Machine vibrates a lot during spin	Washing machine not completely level. Transit brackets not removed yet. Load not distributed evenly.	Adjust the special adjustable feet. Remove transit brackets. Rearrange the laundry evenly.
7. Door will not open	Two minutes have not elapsed since the programme finished.	Wait two minutes.

The machine makes a different noise when spinning! This is because it has a brush motor for better performance.

Only a small level of water can be seen in the drum! This is because new machines do not use much water, yet achieve the same standard of washing and rinsing.

Note:

The use of environmentally-friendly, phosphate-free detergents can have the following effects:

- waste water from rinsing may be cloudier because of the presence of zeolites held in suspension, without the rinse performance being adversely affected;
- presence of white powder (zeolites) on laundry after washing, which is not absorbed by the fabric and does not alter the colour of the fabric.
- The presence of foam in the final rinsing water is not necessarily an indication of poor rinsing.
- Anionic surfactants used in washing detergent formulae often prove to be difficult to remove from the laundry itself and, even in small quantities, can still cause considerable foam production.
- Carrying out more rinse cycles does not serve any purpose in such cases.

This appliance is marked according to the European directive 2002/96/EC on Waste Electrical and Electronic Equipment (WEEE).

By ensuring this product is disposed of correctly, you will help prevent potential negative consequences for the environment and human health, which could otherwise be caused by inappropriate waste handling of this product.

The symbol on the product indicates that this product may not be treated as household waste. Instead it shall be handed over to the applicable collection point for the recycling of electrical and electronic equipment. Disposal must be carried out in accordance with local environmental regulations for waste disposal.

For more detailed information about treatment, recovery and recycling of this product, please contact your local city office, your household waste disposal service or the shop where you purchased the product.

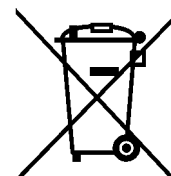

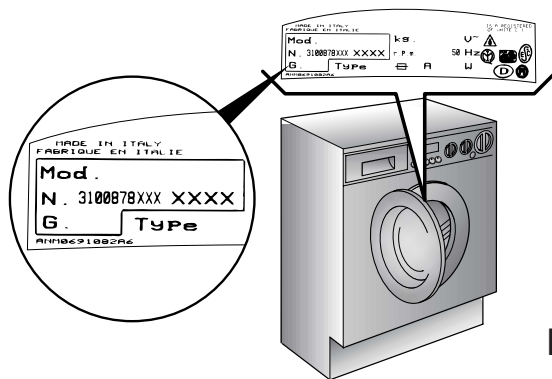

Fig. 2

Technical data

- Max. load of dry laundry for washing
- Water pressure
- Cold fill only
- Spin speed

Measurements

- Width
- Depth
- Height

6 kg
0,05 ÷ 0,8 MPa

1200 r.p.m.

60 cm
54 cm
82 cm

NB: For specifications regarding electrical data, see the data panel on the front of the washing machine (porthole area) - as shown in diagram above.

CE Appliance complies with European Directives 73/23/EEC and 89/336/EEC, replaced by 2006/95/EC and 2004/108/EC, and subsequent amendments.

SETTING UP + INSTALLATION

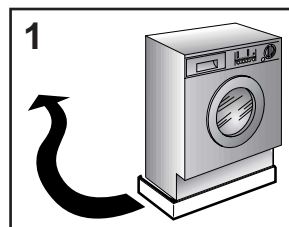

Remove the polystyrene base and place the machine near its permanent position (diagram 1).

Carefully cut through the hose retaining clip at the rear of the appliance (diagram 2).

Remove the 4 fixing screws marked (A) and remove the 4 spacers marked (B) (diagram 3).

For some models 1 or more spacers will fall inside the machine;

By tilting the machine, remove the mentioned spacers.

Cover the 4 holes using the caps provided in the instruction booklet pack (diagram 4).

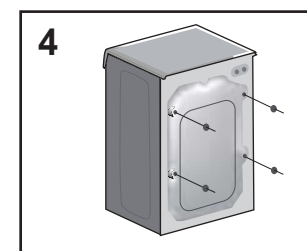
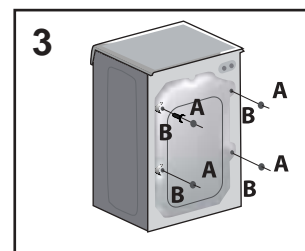
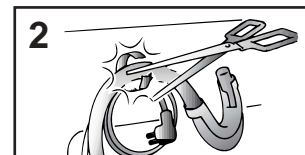

WARNING:

DO NOT LEAVE THE PACKAGING WITHIN REACH OF CHILDREN AS IT IS A POTENTIAL SOURCE OF DANGER.

Apply the insulation sheet of corrugated material to the base as shown.

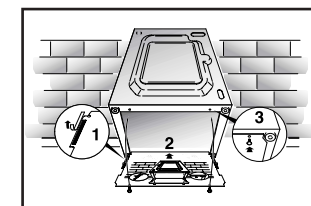

Note: We recommend you keep the transit bracket, braces and screws to immobilise the machine for future transit.

The Manufacturers will not be responsible for any possible damage to the machine caused by not following the rules relating to releasing the mechanism. The user is responsible for all costs of installation.

Installation & Decor Door Fitting

The appliance requires the following space:

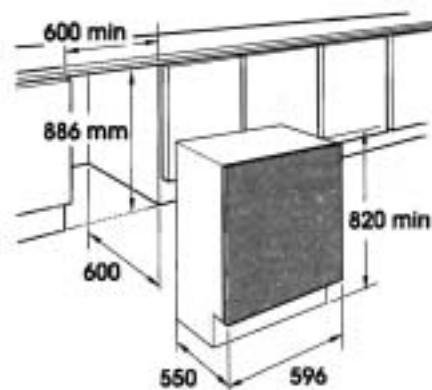

Adjustable Feet

The feet are adjustable to give an appliance height of 825 mm – 849 mm. It is important that the feet are adjusted to ensure that the appliance is level, this is essential to ensure quiet operation. Once the feet have been adjusted to the correct height it is important that they are locked in position using the locking nuts.

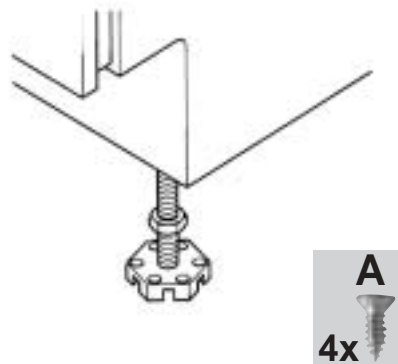

Fitting the Décor Door

The front of the appliance has been drilled to accommodate the hinges to enable the door to be opened from the left or right hand side. We suggest you proceed as follows:

1) Standard Height Door & Dummy Drawer Front

Screw the hinges onto the décor door, 'A' then fasten the dummy drawer front to the top edge of the door. Ensure that the gap between the door & drawer front matches the units on either side.

Fasten the magnetic catch 'B' using screw 'C' to the décor door.

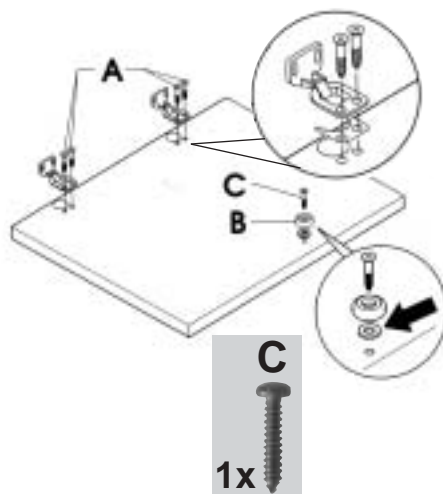

Fasten the magnetic catch striker plate 'D' to the front of the appliance, placing the rubber washer 'E' under the plate and screw in place with screws 'G'.

Snap mount plastic cover cap 'H' into the lower hinge position.

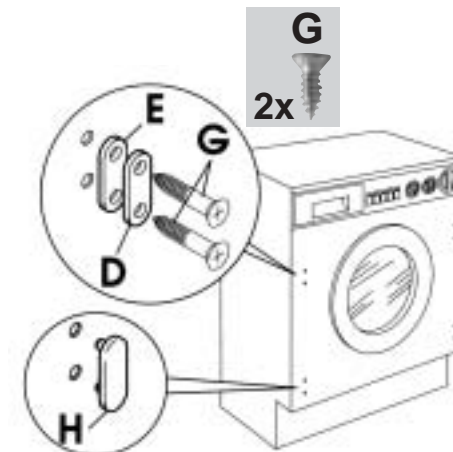

Mount the door and hinges to the front of the appliance using screws 'L'.

Note: It is recommended that where possible the décor door is hinged on the same side as the appliance door as this will give greater space to load and unload the washing.

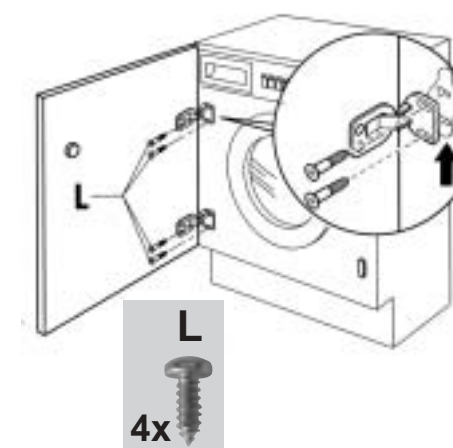

Décor Strip

A décor strip is required to fill the gap between the top of the appliance and the underside of the worktop. We recommend that fascia SKD4189 is used for this purpose and is screwed to the underside of the work or by KD fixings to the adjacent cabinets.

Note: The infill fascia may need to be cut to fit dependant on the height of the appliance.

2) Full Height Door

If a full height door is being used then a top hinge hole will have to be drilled in the door. The distance between the two hinge holes centres is 384mm and 21.5mm from the edge of the door.

The hole diameter for the hinge is 35mm and should be drilled to a depth of 12mm, care must be taken to ensure that you do not drill through the door. The pilot holes for fixing the hinge should be drilled with 2mm diameter drill.

Water connection

The appliance must be connected to the water mains using new hose-sets.

The old hose-sets should not be re-used.

The machine has an inlet hose with 3/4" B.S.P threaded end connection to attach between the threaded connector on the appliance and the cold water supply.

This machine only uses cold water, therefore only one hose is needed to connect to the cold water supply. Do not connect to the hot supply. Cold fill is an energy efficient system. Only the water required for the washing is heated. There is no loss of heat in the pipeline from a hot water tank or boiler to the machine.

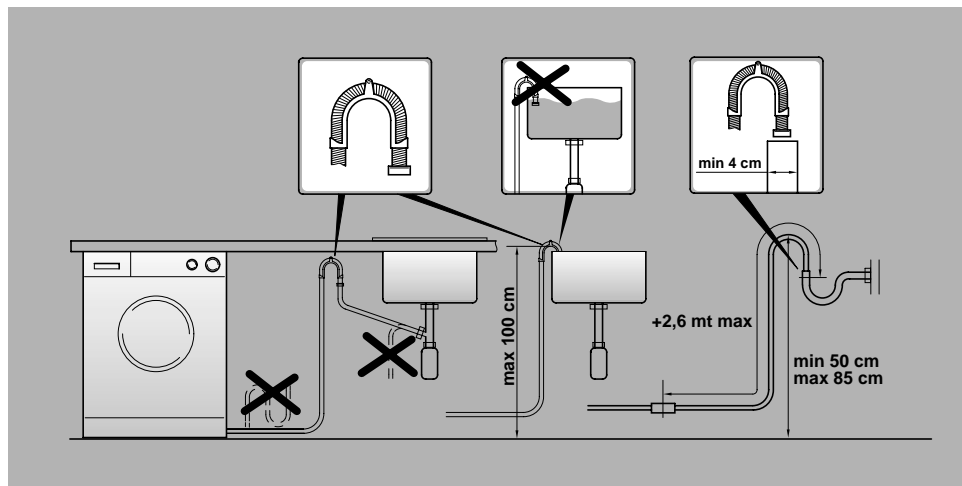
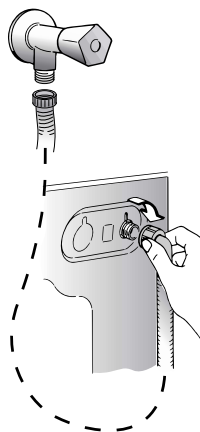

Note: It is advisable to turn off the tap after each wash to isolate the washing machine from the water supply.

For the washing machine to function properly the terminal end of the discharge hose (mouth) must be at a minimum of 50 cm and a maximum of 85 cm from the ground.

ELECTRICAL CONNECTIONS

After installation, the appliance must be positioned so that the plug is accessible.

If the plug we supply does not fit

CUT IT OFF AND DESTROY IT!

You can't use it on other appliances, and the exposed wires could be dangerous if plugged in.

To fit a replacement plug, proceed as follows:

Connect	to the terminal in the plug
green and yellow wire	marked with the letter E, OR marked with the symbol,  OR coloured green, OR coloured green and yellow.
blue wire	marked N OR coloured black.
brown wire	marked L OR coloured red.

WARNING

This appliance must be earthed

Fuses and plugs

This appliance should be used only on a socket with a minimum rating of 13 Amp.

Our ready-fitted plug is already equipped with a 13 amp fuse which is BS 1362 ASTA approved. Any replacement should be exactly the same.

If the fuse cover is lost, do not use the plug until it is replaced. A correct replacement fuse cover (obtainable from your local retailer) must be the same colour as shown or named on the insert on the base of the plug.

The manufacturer declines all responsibility in the event of any printing mistakes in this booklet. The manufacturer also reserves the right to make appropriate modifications to its products without changing the essential characteristics.

12 MONTHS GUARANTEE



Procedure when reporting a fault

1. Give full name, address including post code home telephone number and business telephone number if appropriate.
2. Quote sales receipt number, make and model number of faulty appliance. This product's reference is: **HJA 8514**
3. Give a summary of the problem.

